



RN-6743

B. E. - III (Sem. V) (Civil) Examination

May / June - 2010

Building Design & Drawing

Time : Hours]

[Total Marks : 100

Instructions :

(1)

नीचे दशांशविक निशानीवाणी विगतो उत्तरवडी पर अवश्य वजवी. Fillup strictly the details of signs on your answer book.	Seat No. :
Name of the Examination :	<input type="text"/>
B. E. - 3 (Sem. 5) (Civil)	<input type="text"/>
Name of the Subject :	<input type="text"/>
Building Design & Drawing	<input type="text"/>
Subject Code No. : <input type="text"/> 6 <input type="text"/> 7 <input type="text"/> 4 <input type="text"/> 3	Section No. (1, 2,.....) : <input type="text"/> 1&2
Student's Signature	

- (2) Answers to the two sections must be written in separate drawing sheet.
- (3) Give all dimensions in the figure.
- (4) Draw neat sketches to support your answers.
- (5) Weightage will be given to neatness.

SECTION - I

- 1 Answer the following questions in brief. 10
 - (i) Explain Grouping and Roominess factor.
 - (ii) What is set-back?
 - (iii) Define F.S.I. and F.S.I. suggested by SUDA.
 - (iv) Write classification of building according to building bye-laws.
 - (v) Explain any two principles of architectural composition.

- 2 Explain living area, sleeping area and service area of a building. 5

OR

What is building bye-laws? Write its objectives.

- 3 (a) A semi detached building has plot size $36\text{ m} \times 24\text{ m}$, 15
prepare ground floor plan and first floor plan for it.

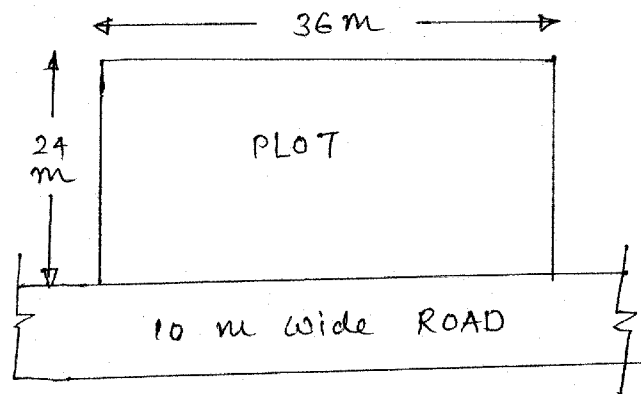

- (i) Allowable F.S.I. - 1.2
 - (ii) Draw front elevation and schedule of opening.
 - (iii) Follow principles of planning and building bye laws.
- (b) Draw foundation plan for the planning developed in 10
Q.3 (a)

OR

- (b) Draw section passing through the stair case in planning
of (Q.3) (a)

SECTION - II

- 4 It is proposed to construct hostel building to 20
accommodate 200 students including 50 post graduate student
in engineering college campus.
The post graduate students will have single bedded rooms.
Provide common hall, dinning hall, and kitchen sanitary unit
as per norms. Design and plan hostel. Also draw elevation for
drawn plan.

5 Draw a two point perspective view for the following :

15

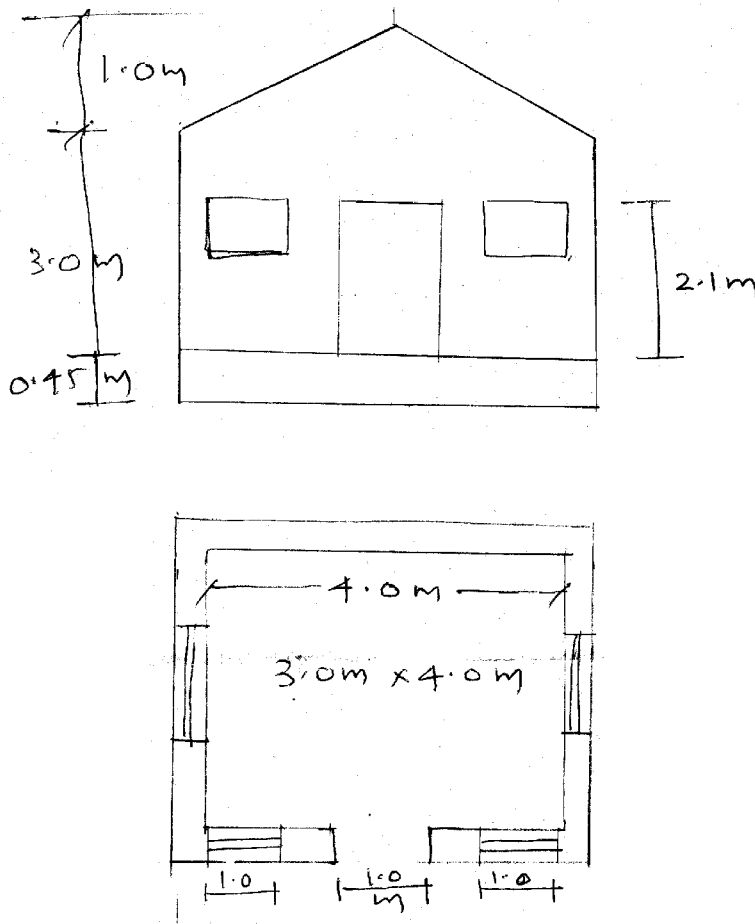

6 (a) Design a Doglegged stair and draw plan and elevation having clear head room 3.0 m and assume suitable data. 10

(b) Differentiate between orientation of building in tropical climate and temperate climate. 5

OR

(b) Importance of landscaping in modern building.